

**CALL FOR QUALIFICATIONS FOR JOHNSON CITY, TENNESSEE
DECORATIVE RAILING PROJECT**

The Public Art Committee of Johnson City, Tn. is seeking qualifications from artists or art teams for the commission of a decorative railing in a pollination-themed park in downtown Johnson City, Tn.

ELIGIBILITY: This opportunity is open to all professional artists over the age of 18. Refer to the Selection Criteria listed below for additional requirements.

BUDGET: Up to three finalists will be selected to develop concept proposals for this project. The total project budget for the selected commission is not to exceed \$120,000. Each finalist will be paid a \$500 stipend for his/her proposal. The selected artist will be paid up to \$118,500 for the commissioned work. Artists are responsible for own travel costs, materials, housing, and personal liability insurance.

DEADLINE: January 9, 2017

QUESTIONS: Cheyenne Peavler cpeavler@johnsoncitytn.org 423-975-2706

Johnson City, with an elevation of over 2000 feet, is located in the foothills of the Appalachian Mountains. It is surrounded by farmland, undulating hills, lush valleys, and many lakes and rivers. Johnson City has an abundance of unspoiled natural beauty and four distinct seasons.

The eighth-largest city in Tennessee, with a population of 65,000, Johnson City was founded in 1856 and later became a major rail hub for the Southeast.

Johnson City is distinguished as a community that embraces art, the environment, commerce, science, community, and education. It is home to a broad based economy and to East Tennessee State University.

PROJECT DESCRIPTION

Johnson City is restoring and enhancing a portion of the Brush and King Creek watersheds through the development of a new park in the heart of the city. With a focus on sustainability, storm water mitigation, and pollination, the park design will allow for increased storm water storage capacity and include features such as terraced grass areas with stone seat walls, on-street parking utilizing permeable pavers, a loop trail, glowing pathway, LED lighting, plaza areas, and native landscaping. The park will also include a new mural on an adjacent building, and future interactive art pieces and water features.

The design includes three wall sections that will require protective guardrails, located over the three culvert headwalls. The walls will be constructed of a segmental Redi-Rock product called Ledgestone, and will be natural, earth tone colors. The park layout and locations of the walls and railings are indicated on Exhibit A – Hardscape Improvements Plan.

It is the desire of the Johnson City Public Art Committee that these railings be public art pieces that complement the park design and further integrate the themes of sustainability and the watershed environment. The guardrails shall be decorative metal railings, utilizing materials that will withstand exposure to water during flooding conditions, and not be malleable by the human hand. The support posts shall be core drilled and grouted into the wall cap (in the field) to accommodate the proposed railing design. Building code requires the guardrail height to be 42 inches tall, and have no openings that will allow a 4 inch sphere to pass through. The approximate length of the three railings is as follows.

Railing #1 (Culvert at King Street) – 30'-6"

Railing #2 (Culvert at McClure Street) – 102'-0"

Railing #3 (Culvert at Commerce Street) – 160'-0"

The Johnson City Public Library, commercial/retail buildings and a future amphitheatre site border the park area. Within walking distance are inviting destinations such as Founders Park, the Pavilion (Farmers Market), and a variety of specialty shops and restaurants.

The selected artist will be responsible for providing design (including structural design and post spacing), fabrication and installation. The artist will coordinate with the General Contractor on installation. City crews will provide on-going maintenance and cleaning. In the qualifications statement, the artist shall demonstrate previous experience with installed pieces, similar in style and scale to this project. Three finalists will be selected to provide a more detailed proposal, including design concept, budget information and a maintenance plan.

SITE MAP

EXHIBIT A



GENERAL NOTES:

1. ALL DIMENSIONS ARE TO FACE UNLESS NOTED OTHERWISE.
2. ALL DIMENSIONS ARE TO FACE UNLESS NOTED OTHERWISE.
3. ALL DIMENSIONS ARE TO FACE UNLESS NOTED OTHERWISE.
4. ALL DIMENSIONS ARE TO FACE UNLESS NOTED OTHERWISE.
5. ALL DIMENSIONS ARE TO FACE UNLESS NOTED OTHERWISE.
6. ALL DIMENSIONS ARE TO FACE UNLESS NOTED OTHERWISE.
7. ALL DIMENSIONS ARE TO FACE UNLESS NOTED OTHERWISE.
8. ALL DIMENSIONS ARE TO FACE UNLESS NOTED OTHERWISE.
9. ALL DIMENSIONS ARE TO FACE UNLESS NOTED OTHERWISE.
10. ALL DIMENSIONS ARE TO FACE UNLESS NOTED OTHERWISE.

KEY:

- 1. RAILING #1
- 2. RAILING #2
- 3. RAILING #3
- 4. MURAL WALL LOCATION
- 5. CREEK CHANNELS
- 6. STORMWATER INFLOW CHANNELS
- 7. STORMWATER OUTFLOW CHANNELS
- 8. PLAZA
- 9. PLAZA
- 10. PLAZA
- 11. PLAZA
- 12. PLAZA
- 13. PLAZA
- 14. PLAZA
- 15. PLAZA
- 16. PLAZA
- 17. PLAZA
- 18. PLAZA
- 19. PLAZA
- 20. PLAZA
- 21. PLAZA
- 22. PLAZA
- 23. PLAZA
- 24. PLAZA
- 25. PLAZA
- 26. PLAZA
- 27. PLAZA
- 28. PLAZA
- 29. PLAZA
- 30. PLAZA
- 31. PLAZA
- 32. PLAZA
- 33. PLAZA
- 34. PLAZA
- 35. PLAZA
- 36. PLAZA
- 37. PLAZA
- 38. PLAZA
- 39. PLAZA
- 40. PLAZA
- 41. PLAZA
- 42. PLAZA
- 43. PLAZA
- 44. PLAZA
- 45. PLAZA
- 46. PLAZA
- 47. PLAZA
- 48. PLAZA
- 49. PLAZA
- 50. PLAZA
- 51. PLAZA
- 52. PLAZA
- 53. PLAZA
- 54. PLAZA
- 55. PLAZA
- 56. PLAZA
- 57. PLAZA
- 58. PLAZA
- 59. PLAZA
- 60. PLAZA
- 61. PLAZA
- 62. PLAZA
- 63. PLAZA
- 64. PLAZA
- 65. PLAZA
- 66. PLAZA
- 67. PLAZA
- 68. PLAZA
- 69. PLAZA
- 70. PLAZA
- 71. PLAZA
- 72. PLAZA
- 73. PLAZA
- 74. PLAZA
- 75. PLAZA
- 76. PLAZA
- 77. PLAZA
- 78. PLAZA
- 79. PLAZA
- 80. PLAZA
- 81. PLAZA
- 82. PLAZA
- 83. PLAZA
- 84. PLAZA
- 85. PLAZA
- 86. PLAZA
- 87. PLAZA
- 88. PLAZA
- 89. PLAZA
- 90. PLAZA
- 91. PLAZA
- 92. PLAZA
- 93. PLAZA
- 94. PLAZA
- 95. PLAZA
- 96. PLAZA
- 97. PLAZA
- 98. PLAZA
- 99. PLAZA
- 100. PLAZA

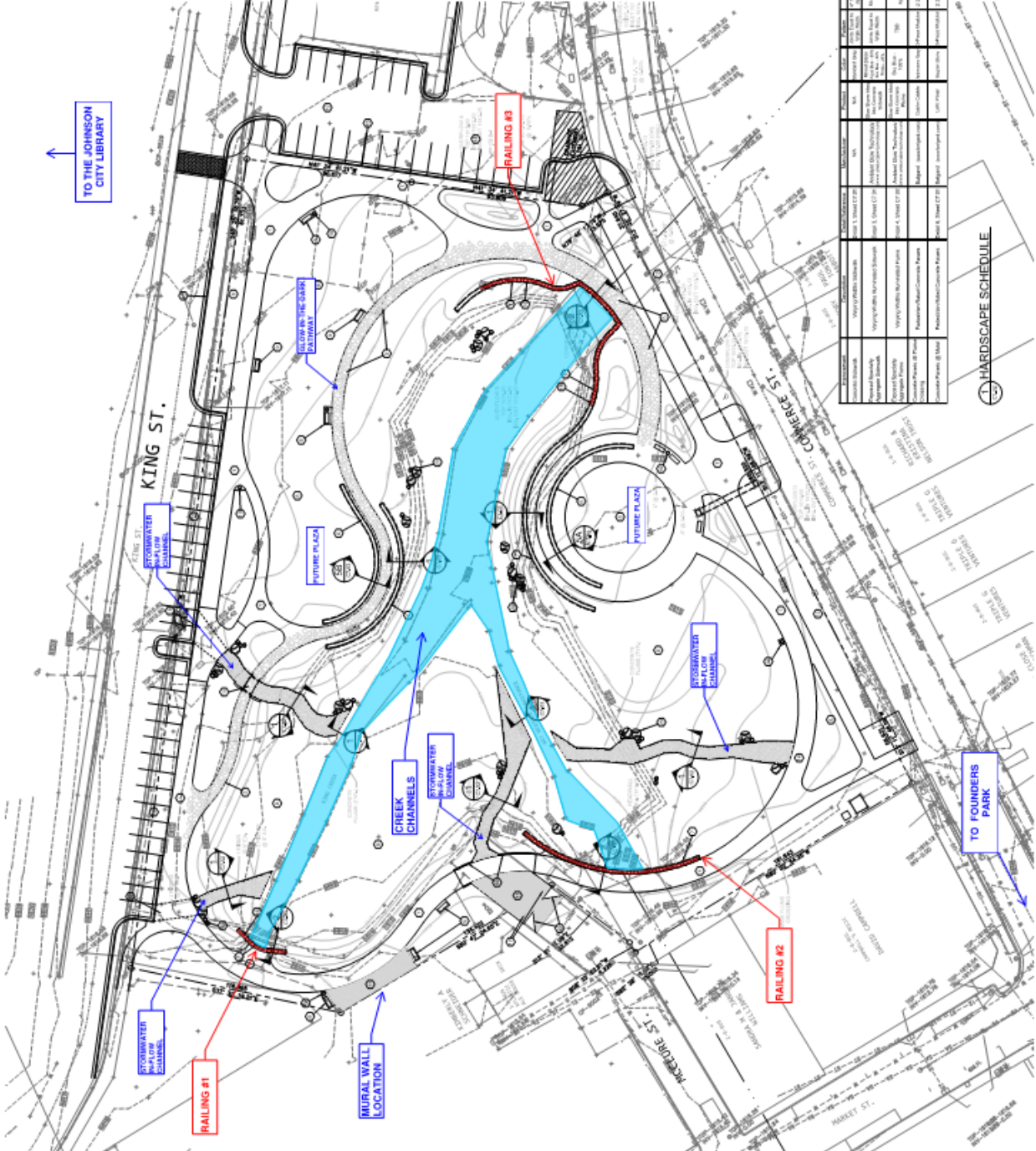

Item	Quantity	Unit	Notes
1. RAILING #1	100	Linear Feet	See Notes
2. RAILING #2	100	Linear Feet	See Notes
3. RAILING #3	100	Linear Feet	See Notes
4. MURAL WALL LOCATION	1	Area	See Notes
5. CREEK CHANNELS	100	Linear Feet	See Notes
6. STORMWATER INFLOW CHANNELS	100	Linear Feet	See Notes
7. STORMWATER OUTFLOW CHANNELS	100	Linear Feet	See Notes
8. PLAZA	100	Area	See Notes
9. PLAZA	100	Area	See Notes
10. PLAZA	100	Area	See Notes
11. PLAZA	100	Area	See Notes
12. PLAZA	100	Area	See Notes
13. PLAZA	100	Area	See Notes
14. PLAZA	100	Area	See Notes
15. PLAZA	100	Area	See Notes
16. PLAZA	100	Area	See Notes
17. PLAZA	100	Area	See Notes
18. PLAZA	100	Area	See Notes
19. PLAZA	100	Area	See Notes
20. PLAZA	100	Area	See Notes
21. PLAZA	100	Area	See Notes
22. PLAZA	100	Area	See Notes
23. PLAZA	100	Area	See Notes
24. PLAZA	100	Area	See Notes
25. PLAZA	100	Area	See Notes
26. PLAZA	100	Area	See Notes
27. PLAZA	100	Area	See Notes
28. PLAZA	100	Area	See Notes
29. PLAZA	100	Area	See Notes
30. PLAZA	100	Area	See Notes
31. PLAZA	100	Area	See Notes
32. PLAZA	100	Area	See Notes
33. PLAZA	100	Area	See Notes
34. PLAZA	100	Area	See Notes
35. PLAZA	100	Area	See Notes
36. PLAZA	100	Area	See Notes
37. PLAZA	100	Area	See Notes
38. PLAZA	100	Area	See Notes
39. PLAZA	100	Area	See Notes
40. PLAZA	100	Area	See Notes
41. PLAZA	100	Area	See Notes
42. PLAZA	100	Area	See Notes
43. PLAZA	100	Area	See Notes
44. PLAZA	100	Area	See Notes
45. PLAZA	100	Area	See Notes
46. PLAZA	100	Area	See Notes
47. PLAZA	100	Area	See Notes
48. PLAZA	100	Area	See Notes
49. PLAZA	100	Area	See Notes
50. PLAZA	100	Area	See Notes
51. PLAZA	100	Area	See Notes
52. PLAZA	100	Area	See Notes
53. PLAZA	100	Area	See Notes
54. PLAZA	100	Area	See Notes
55. PLAZA	100	Area	See Notes
56. PLAZA	100	Area	See Notes
57. PLAZA	100	Area	See Notes
58. PLAZA	100	Area	See Notes
59. PLAZA	100	Area	See Notes
60. PLAZA	100	Area	See Notes
61. PLAZA	100	Area	See Notes
62. PLAZA	100	Area	See Notes
63. PLAZA	100	Area	See Notes
64. PLAZA	100	Area	See Notes
65. PLAZA	100	Area	See Notes
66. PLAZA	100	Area	See Notes
67. PLAZA	100	Area	See Notes
68. PLAZA	100	Area	See Notes
69. PLAZA	100	Area	See Notes
70. PLAZA	100	Area	See Notes
71. PLAZA	100	Area	See Notes
72. PLAZA	100	Area	See Notes
73. PLAZA	100	Area	See Notes
74. PLAZA	100	Area	See Notes
75. PLAZA	100	Area	See Notes
76. PLAZA	100	Area	See Notes
77. PLAZA	100	Area	See Notes
78. PLAZA	100	Area	See Notes
79. PLAZA	100	Area	See Notes
80. PLAZA	100	Area	See Notes
81. PLAZA	100	Area	See Notes
82. PLAZA	100	Area	See Notes
83. PLAZA	100	Area	See Notes
84. PLAZA	100	Area	See Notes
85. PLAZA	100	Area	See Notes
86. PLAZA	100	Area	See Notes
87. PLAZA	100	Area	See Notes
88. PLAZA	100	Area	See Notes
89. PLAZA	100	Area	See Notes
90. PLAZA	100	Area	See Notes
91. PLAZA	100	Area	See Notes
92. PLAZA	100	Area	See Notes
93. PLAZA	100	Area	See Notes
94. PLAZA	100	Area	See Notes
95. PLAZA	100	Area	See Notes
96. PLAZA	100	Area	See Notes
97. PLAZA	100	Area	See Notes
98. PLAZA	100	Area	See Notes
99. PLAZA	100	Area	See Notes
100. PLAZA	100	Area	See Notes

HARDSCAPE SCHEDULE



SELECTION CRITERIA

The Johnson City Public Art Committee will review the qualifications of applicant artists and will select three finalists. Their selections will be based on the following criteria:

- Artistic excellence as demonstrated in 10 digital images of the artist(s) previous work
- Experience in design and installation of projects of a similar type and scale
- Experience working in community settings
- Willingness to meet all contractual guidelines
- The use of content appropriate for all audiences
- Ability to interact with public for educational purposes

SUBMISSION GUIDELINES:

Submissions shall include the following:

- Cover letter/letter of intent
- Digital portfolio (10 digital images of previous art work)
- Artist's resume'
- Contact information for 3 professional references

PROJECT SCHEDULE

Deadline for Application: January 9, 2017

Notification of three finalists: January 16, 2017

Finalist Proposals Due: February 6, 2017

Final Artist Selection: February 16, 2017

The anticipated construction schedule for the overall park is as follows:

Notice to Proceed with Construction – December 26, 2016

Final Completion – July 26, 2017

Installation of the railing will be scheduled in consultation with the selected artist and the General Contractor for the park construction. The railing must be complete prior to the park opening. When submitting your RFQ, please confirm that you can work within the construction schedule noted above.

LIST OF RESOURCES

Phil Pindzola ppindzola@johnsoncitytn.org 423-434-6080

Jennifer Salyer Jennifer.Salyer@bwsc.net 423-723-8448

Submit a digital packet at <http://www.johnsoncitytn.org/art/> under the “Call For Entries” tab.